

**Installation manual**  
**Heat Recovery Pipes™**  
**HRP290 and HRP530**  
**for electrically heated tumble dryers**

487 19 43 41/00  
GB 00.20



## Contents:

<b>Installation:</b> .....	4
Dimension sketch	
HRP unit connected to external channels	
Technical data	
Unpacking	
Assembly	
Service inspection of the dryer.	

The manufacturer reserves the right to modify design and material specifications without notice.

### **Safety instructions.**

**General maintenance of the HRP unit must be maintained.**

**If the HRP unit is not maintained, the drying process will not function optimally.**

Dimension sketch

Tumbler type	HRP type	X	Y
TT300/C300/D300/30T/T3290/C3290	HRP290	1120	2540
TT500/C500/D500/50T/T3530/C3530	HRP530	1180	2850
TT750/C650/D750/75T/T3650/C3650	HRP530	1370	3030

HRP	A	B/B1	C/C1	D	E	F	G	H	J	K
HRP290	485	700/730	1510/1470	530	485	354	350	ø315	ø250	1245
HRP530	485	700/730	1575/1470	530	485	255	420	ø315	ø250	1310

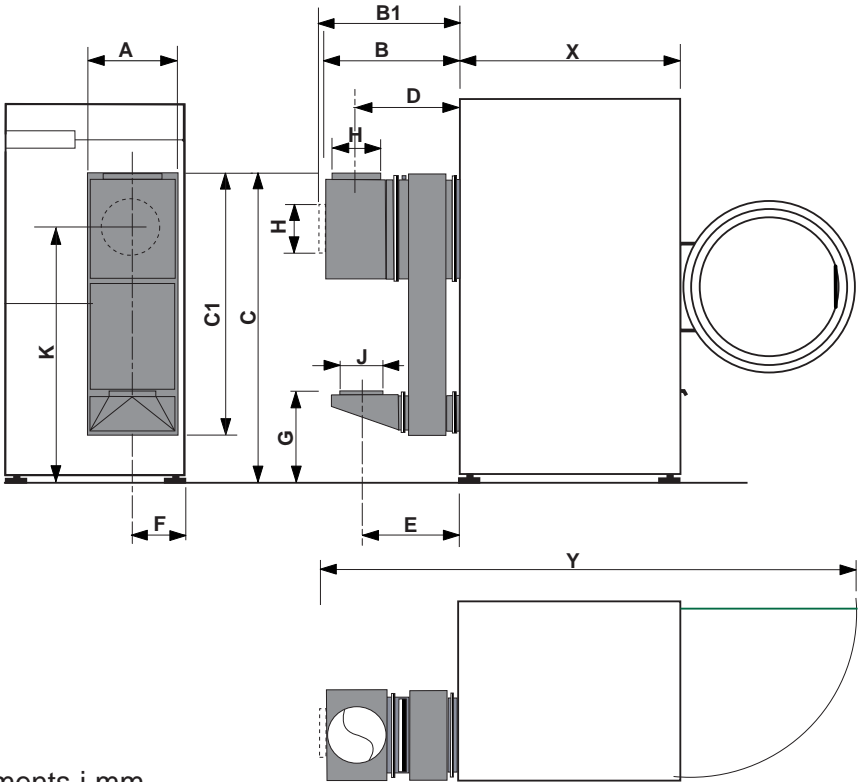

Measurements i mm

## HRP unit connected to external channels

### HRP unit connected to channel for outside air supply

External air supply is always recommended to achieve maximum performance and energy efficiency.

**Channel for external air supply from outside**

**Channel for exhaust**

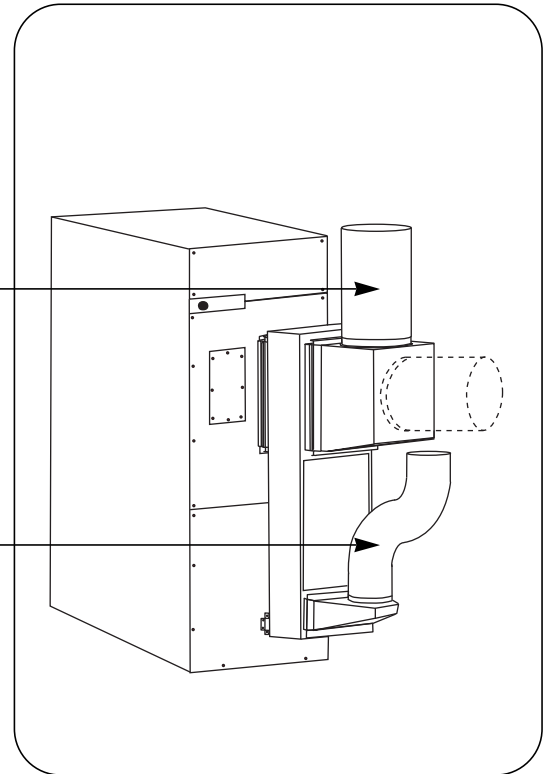

### HRP unit connected with direct air supply from the room

Direct air intake from the room may cause draughts, faster lint built-up in the inlet filter and consequently reduced performance.

**Direct air supply from the room**

**Channel for exhaust**

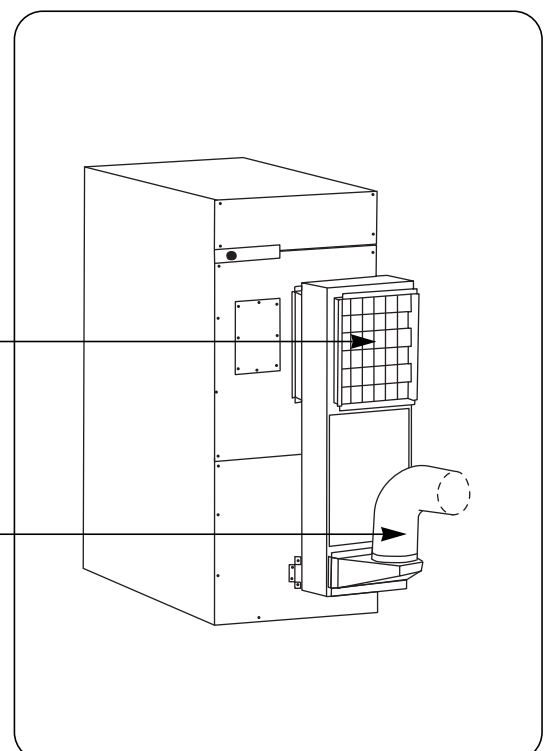

## Technical data, HRP290, HRP530

	<b>HRP 290/530</b>
<b>Weight:</b> (exclusive. connecting piece)	48 kg
<b>Channel connection:</b> Air supply Exhaust	Ø 315 mm Ø 250 mm
<b>Drain in bottom:</b>	Ø 32 mm
<b>Pressure test:</b>	32 bar

## HRP290 and HRP530 mounted on the dryer

<b>Electrically heated tumble dryer type</b>	<b>Air consumption</b>	<b>Pressure drop</b>	<b>HRP type</b>
TT300/C300/D300/30T/T3290/C3290	525 m³/h	ca.50 Pa	HRP290
TT500/C500/D500/50T/T3530/C3530*	950 m³/h	ca. 50 Pa	HRP530
TT750/C650/D750/75T/T3650/C3650	1100 m³/h	ca. 50 Pa	HRP530

\* HRP530 Unit only suitable for dryers produced after 98.04.

## Unpacking Heat Recovery Pipes

**One unit comprises:**

HRP unit (pos.5).

3 pcs rear panels for the tumble dryer (pos. 9,10,11).

Speed nuts to affix the rear panel.

Channel for exhaust air (mounted in the dryer) (pos.1).

Sealing strips and connecting guides incl. corner connections (pos. 2,3).

Combined connecting piece for supply air (vertical and horizontal air supply) (pos.8).

Connecting piece for exhaust air (pos.4).

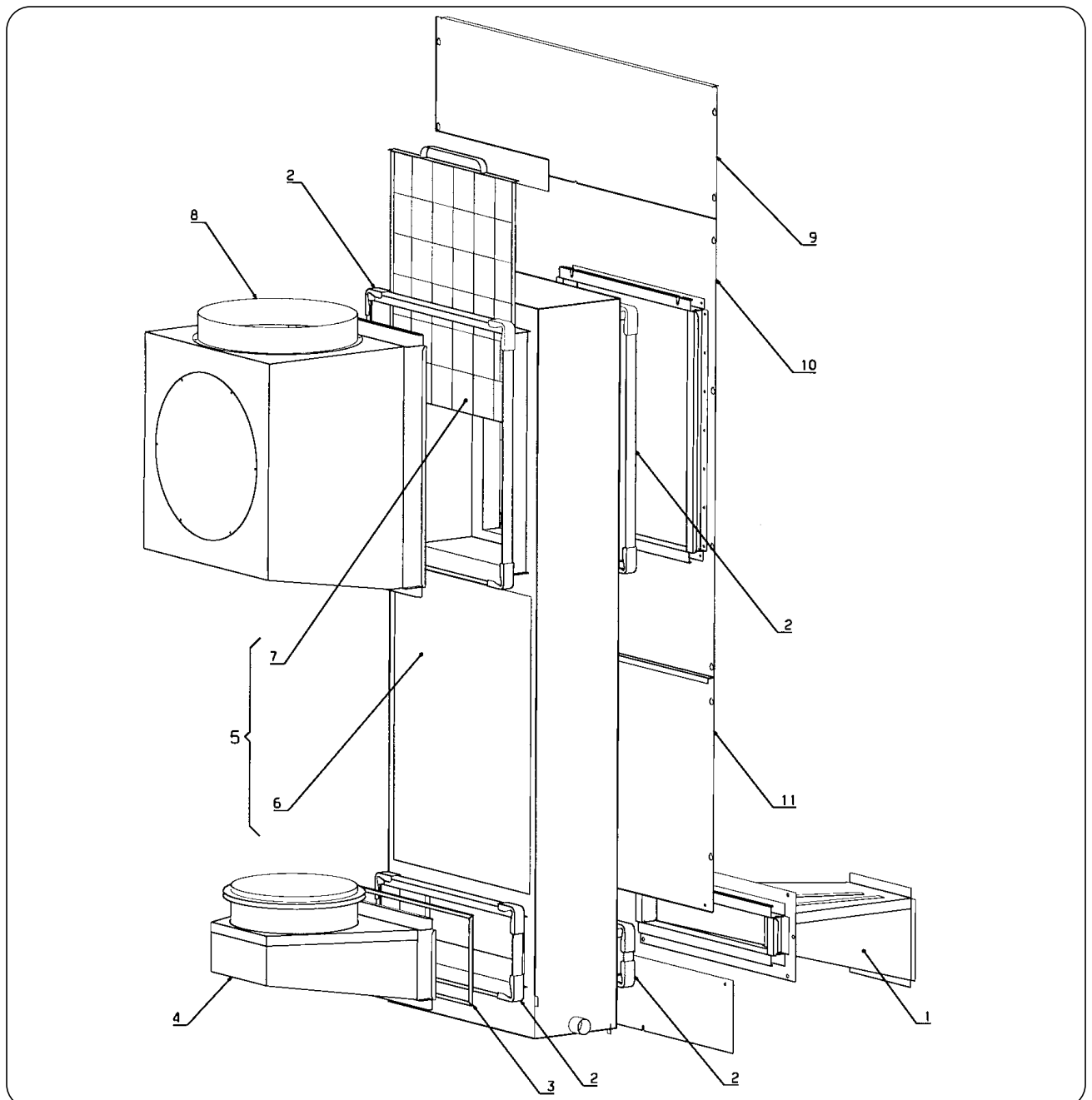

## Dismantling parts of the dryer

The HRP unit cannot be mounted on the existing rear panel on the tumble dryer.

Therefore, a rear panel is enclosed together with the unit - this panel is in three pieces (**a + b + c**).

Dismantle the following before mounting the new rear panels:

- Existing rear panel.
- Round channel for exhaust air.

## Mounting the HRP unit

- Mount the channel for exhaust air **a** in the dryer.  
On type TT300/C300/D300/30T/T3290/C3290 the channel is secured with 2 new self cutting screws at the bottom. The 2 screws at the top is to be screwed into existing holes.

• Mount the bottom rear panel **b**.

• Mount the middle rear panel **c** with service cover.

• Mount the top rear panel **d**.

## Mounting the HRP unit

- Before mounting the HRP unit, sealing strips must be mounted on all flanges, both at the air supply channel and the exhaust air channel.

### Mount the HRP unit

The two screws at the top of the HRP unit must fit into the two notches in the upper flange at the air supply channel on the back panel of the tumble dryer.

Hang the HRP unit in position.

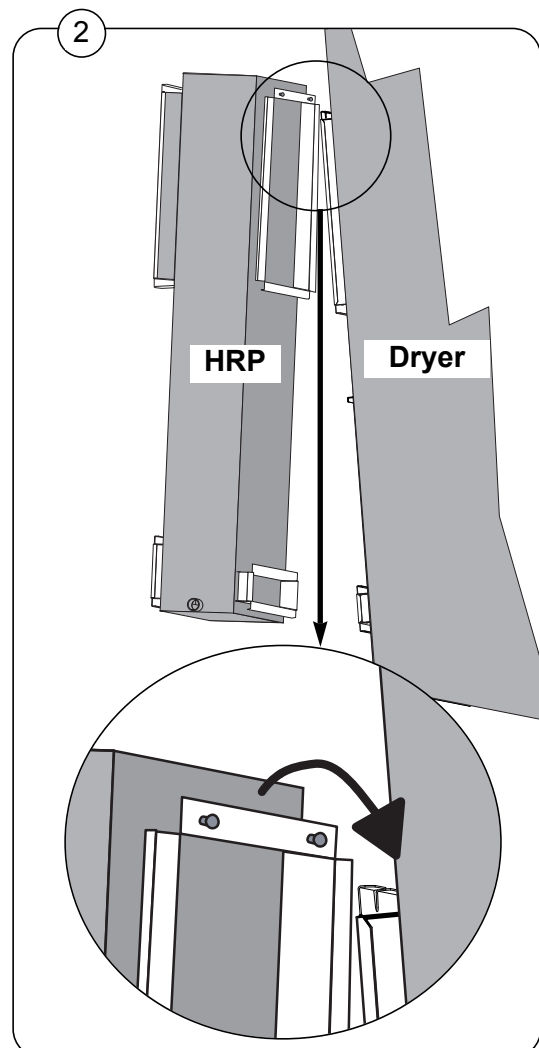
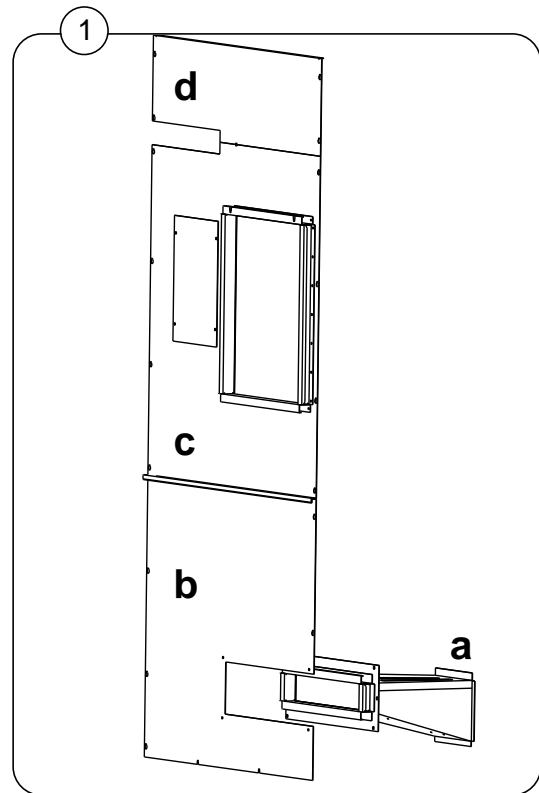



## Assembly (continued)

- ③ Mount the speed nuts at the exhaust channel and the back panel. See arrow. Tighten the back panel.

Slide the connecting guides onto all flanges both at the air supply and the exhaust air channel.

Mount the corner connections at all corners **A** see fig. 4.

## Mounting of connecting pieces

- ④ Before mounting connecting pieces 1 and 2, the sealing strips must be mounted on all flanges, both at the air supply and the exhaust air channel.

Mount the connecting pieces required.

Slide the connecting guides onto all the flanges and mount corner connections on all corners **A**.

Connect the connecting pieces to the external air supply and exhaust system.

Test the tumble dryer.

## Drain

- ⑤ The HRP unit **must** be connected to a drain.

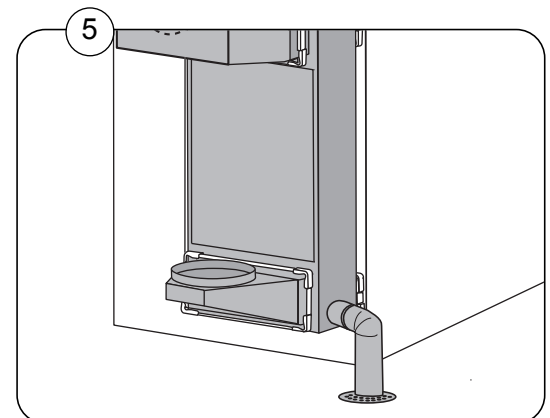
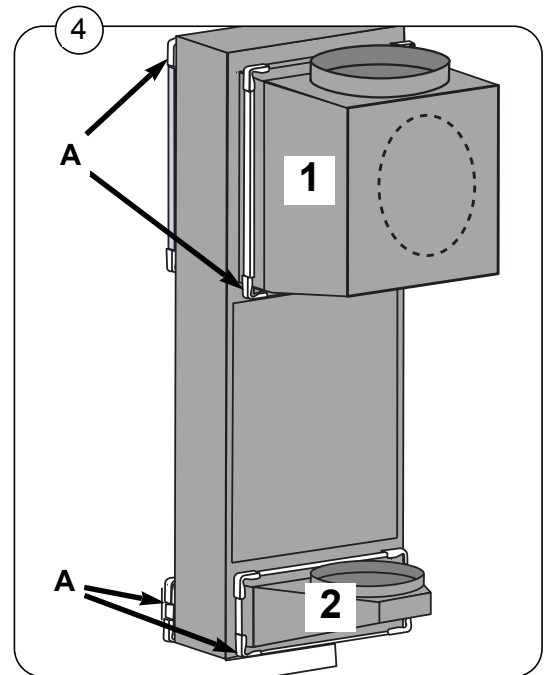
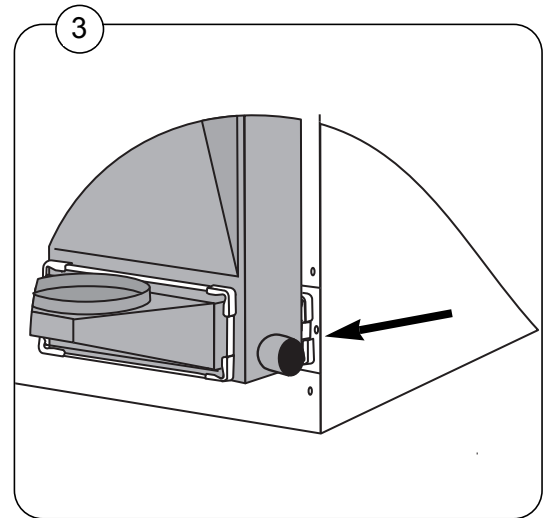

## External air supply channels.

All the air supply channels must be insulated to avoid condensed water outside of the the channels.

## Several tumble dryers on a common ventilation pipe.

- 1 If HRP units are mounted on several tumble dryers, and these are connected to a common ventilation pipe, then a back pressure damper must be mounted on each individual air shaft, immediately after the HRP unit.

This is to prevent the exhaust air from blowing into one of the other tumble dryers.

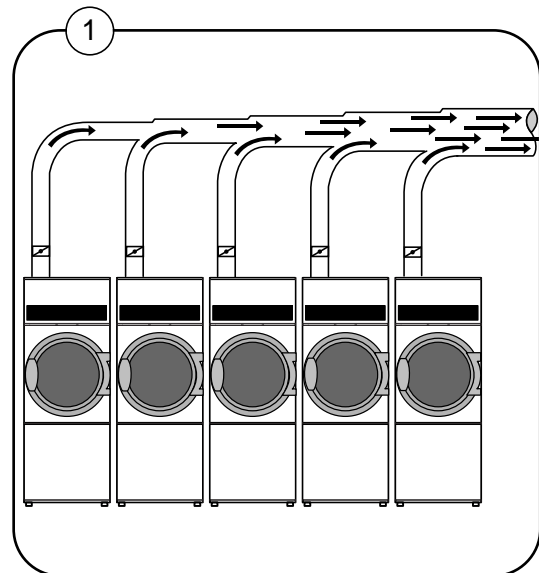

## The service cover

- ① Service cover **A** is only mounted on tumble dryer type:

**TT500/C500/D500/50T/T3530/C3530**

**TT750/C650/D750/75T/T3650/C3650**

To check individual parts in tumble dryers equipped with a HRP unit, the rear panel of the dryer has a service cover **A**, which can be dismounted.

**It is now possible to check:**

Vacuum switch.

RMC - if the dryer is an RMC model.

Belt tension.

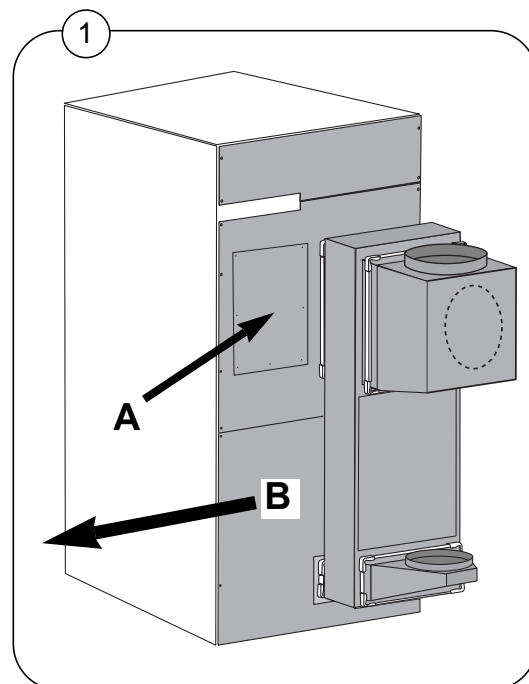

## The bottom rear panel

Rear panel **B** is mounted on all types.

With major service checks, the bottom rear panel **B** must be dismounted.

Remove the screws and pull the panel to one side.

After servicing the machine, push the panel back into position and mount the screws.